

REVISIONS				
ZONE	REV	DESCRIPTION	DATE	APPROVED
	A	New Release	02/11/07	H.T.

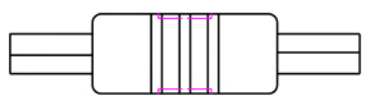
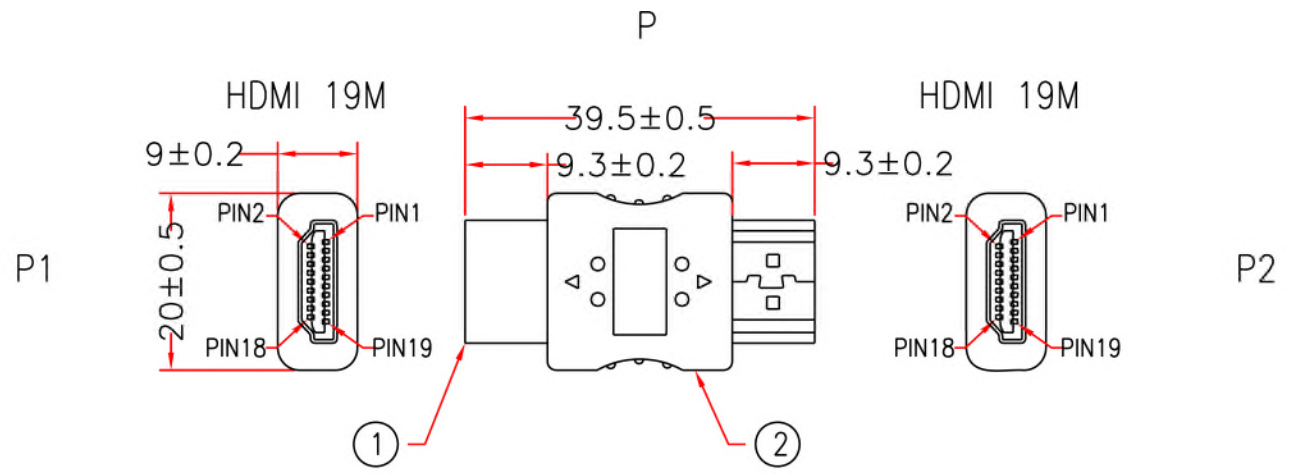

PIN ASSIGNMENT	
P1	P2
1	1
2	2
Σ 1:1	
18	18
19	19
SHIELD	SHIELD

ITEM NO.	MATERIAL / SPECIFICATION	QTY	UNIT
	NON-UL 28 AWG. INSULATOR WIRE, LENGTH 25mm	1	PCS.
	PCB : HDMI	1	PCS.
2.	COPPER FOIL 15 x 60mm	1	PCS.
	TRANSPARENT PE INNER MOLDED	1	PCS.
	BLACK PVC MOLDED HOOD	1	PCS.
1.	HDMI 19 MALE GOLD PLATING 15u ON CONTACTS	2	PCS.

CABLE ASSEMBLY PARTS LIST			
UNLESS OTHERWISE SPECIFIED: 1. DIMENSION ARE IN INCHS 2. TOLERANCES: DECIMALS .XX ±0.25 3. DO NOT SCALE DRAWING 4. REMOVE ALL BURRS AND BREAK SHARP EDGES.		CUSTOMER	
PROPRIETARY DOCUMENT THIS DRAWING AND/OR INFORMATION OR SUBJECT MATTER CONTAINED HEREIN, SHALL NOT BE USED, COPIED OR DISSEMINATED IN ANY MANNER, OR FOR ANY PURPOSE, OTHER THAN AS EXPRESSLY GRANTED BY USBFIREWIRE.COM		CUSTOMER APPROVAL	
DRAWN Howie Tseng		DATE 02/11/07	SCALE NONE
CHECKED		SIZE Adapter	DWG NO. RR-HDMI-AMAM
		Release Date: 02/11/07	SHEET 1 OF 1

www.USBFireWire.com
TITLE
HDMI M / HDMI M GENDER CHANGER

D
C
B
A
FNAME
REVDATE
USER

4 3 2 1

4 3 2 1